

VAN-CASS INTERCOUNTY DRAIN

DRAINAGE DISTRICT

SECTIONS 11-15, 22-23, 26-27 & 33-36
 T4S R13W
 PORTER TOWNSHIP, VAN BUREN COUNTY
 &
 SECTION 1-3 & 11-12
 T5S R13W
 MARCELLUS TOWNSHIP, CASS COUNTY

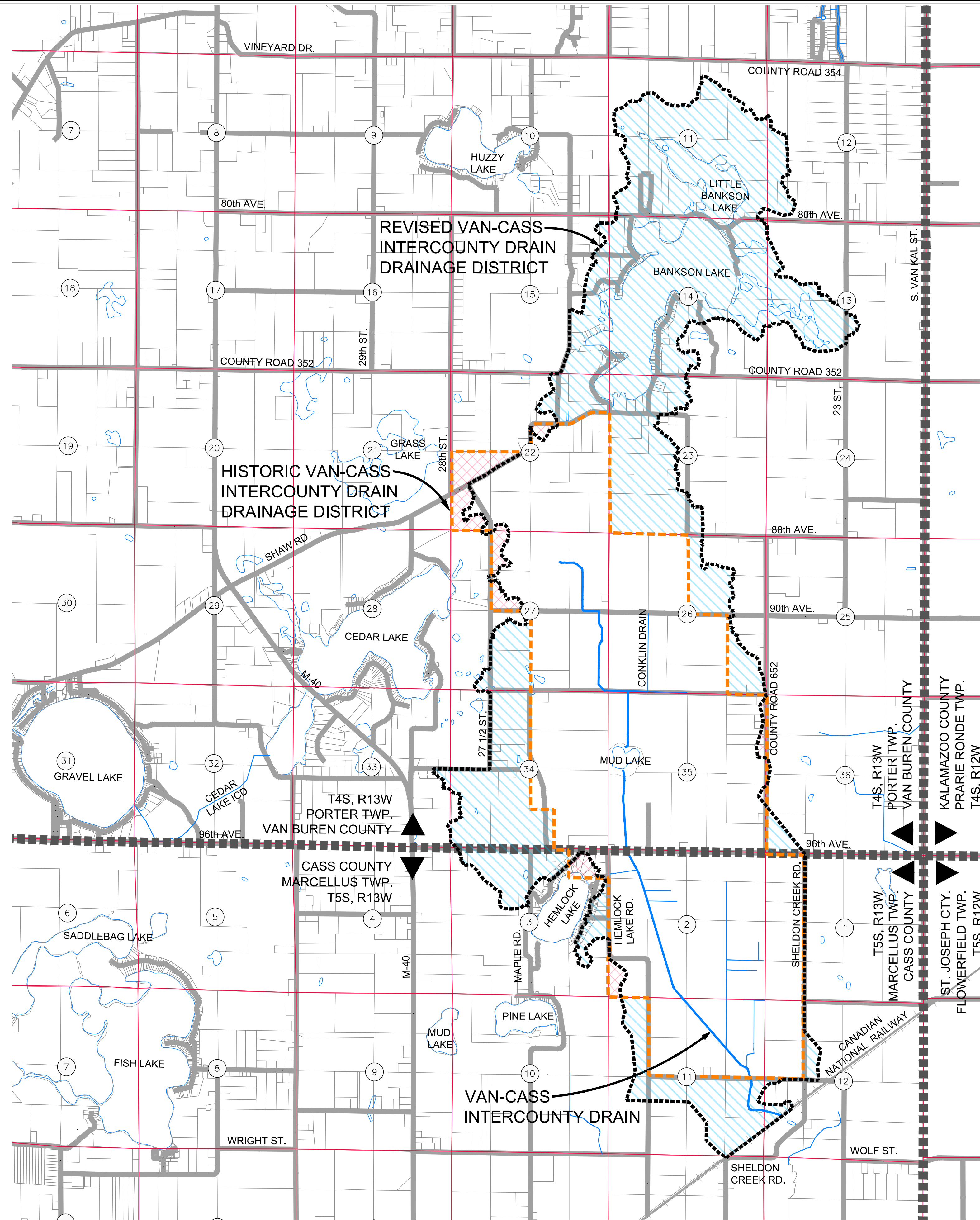

DRAINAGE DISTRICT INFORMATION:

HISTORIC DISTRICT:	3,201.04 ACRES
REVISED DISTRICT:	5,520.52 ACRES
LANDS ADDED:	2,461.09 ACRES
LANDS REMOVED:	141.61 ACRES

DRAIN LENGTH	
VAN-CASS INTERCOUNTY DRAIN	4.30 MILES

LEGEND

- LANDS REMOVED
- LANDS ADDED
- DRAIN ALIGNMENT (OPEN CHANNEL)
- DRAIN ALIGNMENT (ENCLOSED)
- HISTORIC DRAINAGE DISTRICT BOUNDARY
- REVISED DRAINAGE DISTRICT BOUNDARY
- CITY/VILLAGE LIMITS
- PARCEL LINES
- ROADS
- SECTION LINES
- TOWNSHIP LINE
- COUNTY LINE
- SECTION NUMBERS

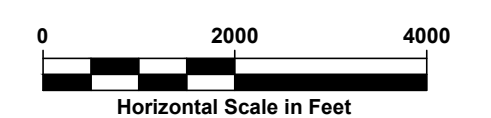
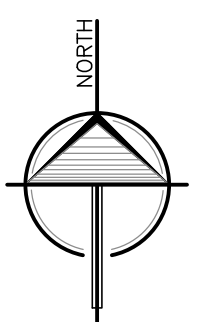

LANDS ADDED/REMOVED MAP EXHIBIT B-1

	2121 3 Mile Rd. NW Walker, MI 49544 Ph: 616-301-7888 www.LREMI.com	PROJECT#: 19-109
		DRAWN BY: KJB
		DATE: 05/28/2020
		QA/QC: NDJ